



Multilanguage manual



Quick Guide

**HEAD OFFICE**

SALUS Controls, Units 8-10,  
Northfield Business Park,  
Forge Way, Parkgate  
Rotherham, S60 1SD

SALUS Controls GmbH,  
Dieselstrasse 34,  
63165 Mühlheim am Main,  
Germany

UK: tech@salus-tech.com  
DE / NL: info@salus-controls.de  
FR: technicalsupport@saluscontrols.fr  
RO: tehnic@saluscontrols.ro  
DK: Support@salus-controls.dk

www.saluscontrols.com



SALUS Controls is a member of the Computime Group  
Maintaining a policy of continuous product development  
SALUS Protect which is made up SALUS Controls and Safe4  
reserves the right to change specification, design and  
materials of products listed in this brochure without prior  
notice.



V01  
XII/2024

**Introduction**

The SALUS WQ615RX receiver is designed for effective management of electric heating systems utilizing the Zigbee protocol. The receiver can be set up as a master unit, allowing it to connect with up to four additional slave receivers, thereby creating a unified and synchronized network for controlling multiple infrared panels. Each WQ615RX receiver can function as either a master or a slave, depending on the system's requirements, ensuring smooth control and integration. This flexibility allows for effortless management of the entire heating or cooling system, improving the efficiency and responsiveness of your setup.

**Product Compliance**

This product complies with the essential requirements and other relevant provisions of Directives 2014/53/EU and 2015/863/EU. The full text of the EU Declaration of Conformity is available at the following internet address: www.saluslegal.com.

Ⓜ 2405-2480MHz, <14dBm

**Safety Information**

To ensure both safety and optimal performance, the WQ615RX receiver should be used in accordance with all relevant regulations. This device is designed exclusively for indoor use and must not be installed in environments exposed to extreme temperatures or other harsh conditions. Keep the receiver completely dry; any inadequate installation may cause damage or malfunction. Always disconnect the power before cleaning and use a dry cloth only. For safe operation, position and install the WQ615RX receiver at a convenient height to allow easy access. The device's maximum operating temperature is 50°C, so avoid placing them in locations that may exceed this limit to prevent overheating.

**Receiver buttons**

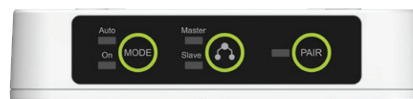

1 2 3

- 1. **MODE button:** Auto/On/Off selection
- 2. **Master/Slave selection:** Master can control up to 4 slaves
- 3. **PAIR button** for quick pairing procedure

**Wiring diagram**

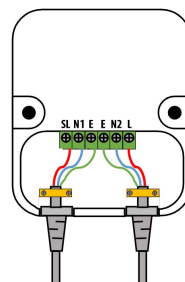

Infrared panel

Power supply

**Pairing process**

**Note:** The WQ615TX thermostat comes prepared with the WQ615RX receiver, which can also be linked to an additional 4 more receivers (5th slave will be rejected), all connected to infrared heating panels. To start a new pairing process, it is necessary to factory reset the devices.



Power up the receiver. PAIR LED will flash red. Slave LED will flash green. Short press the Master/Slave button to change to Master. Press and hold the PAIR button for 10 seconds to reset the master receiver.



The PAIR LED will show solid red for 5 seconds then will start flashing red. Press and hold the PAIR button for 5 seconds to start pairing the master receiver. Master LED and PAIR LED will both flash green.



A few seconds later, Master LED will show solid green. PAIR LED will keep flashing green. Press and hold the PAIR button for 5 seconds. Both PAIR and Master LEDs show solid green. Master receiver is now paired.

**Pairing a slave receiver (optional)**

**Note:** Skip steps 10 - 15 if you only pair one master receiver. Resume pairing from step 16.



Power up the slave receiver. PAIR LED will flash red. Slave LED will flash green. Press and hold the PAIR button for 10 seconds to reset the slave receiver. The Slave LED and PAIR LED will both start flashing green.



Press and hold the PAIR button for 5 seconds ON THE MASTER RECEIVER to start pairing the SLAVE receiver. The PAIR LED on the master receiver will start flashing green. Wait until Slave LED and PAIR LED both show solid green on the slave receiver. Slave receiver is now paired.

**Note:** Repeat the slave pairing process to connect up to a maximum of 4 slaves.

- Resetting the master: master deletes the thermostat, all slaves and coordinator information.
- Resetting the slave: slave deletes its own connection information and leaves the ZigBee network.

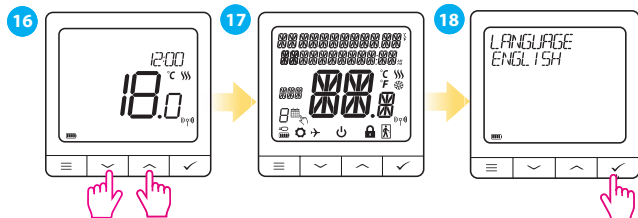

16 Press and hold the UP and DOWN buttons for 5 seconds to reset the thermostat.

17 Display will show all icons.

18 Choose English and press the YES button.

- 19 In the home screen, press the button to enter settings. Then, press the button for a few times, go to [PAIR WITH RECEIVER], press the select YES and press the button again to start pairing with the receiver.



- 20 If paired successfully, the thermostat will display [PAIRING SUCCESSFULL], then, after a few seconds, will go to the home screen.

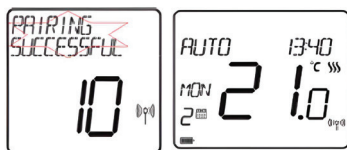

- 21 After setting the temperature on the thermostat, receiver will show solid GREEN LEDs (AUTO, MASTER/SLAVE, PAIR).



**Note:** If the user wants to replace one or more existing paired slave receiver, user MUST let the WQ610TX thermostat, master and slave receivers do factory reset and pair again. In case of mistake or broken receivers, user will need to do factory reset of Master and then redo all pairing process of WQ610TX and Slaves.

**Note:** If master/slaves do not receive RF signal from master for over 1 hour in Auto mode, they will enter fail safe mode. In the fail safe mode, they will turn on relay for 5 min and turn off again for 55 min and repeat until RF signal is reconnected. When reconnected, slaves are re-controlled by master again. In manual ON or OFF mode, no fail safe mode.

## Wiring diagram

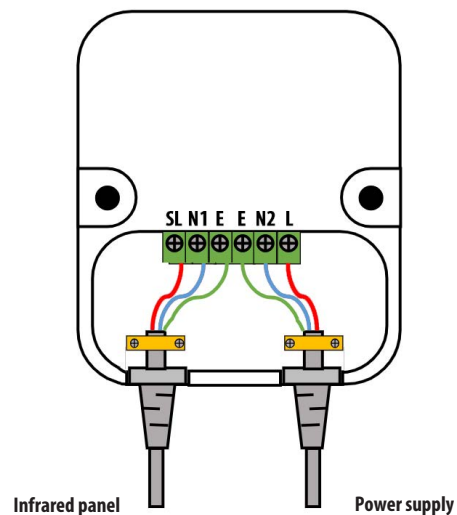

## Dimensions

100mm(W) x 110mm(H) x 22mm (D)

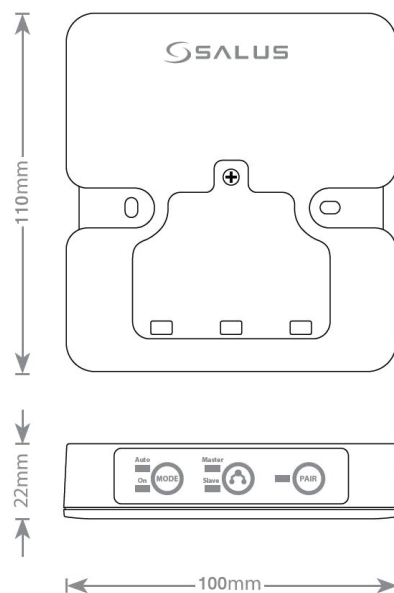

## Receiver specifications

<b>Power Supply Receiver</b>	230V AC 50Hz
<b>Connectivity</b>	Local comm. via ZigBee 2.4 GHz
<b>Rating max</b>	10(5)A
<b>Operating temperature</b>	0°C to +50°C
<b>Storage temperature</b>	-25°C to +60°C
<b>Outputs</b>	230V SL
<b>Ingress protection rating</b>	IP54
<b>Radio frequency</b>	2.4 GHz
<b>Material (Housing)</b>	White, Gloss plastic
<b>Safety approval</b>	Class II
<b>Dimensions</b>	100mm(W) x 110mm(h) x 22mm (D)

## Other perspectives

